

OSBUN ROAD
SCALE 1"=20'

SECTION 9'-9"
NO SCALE

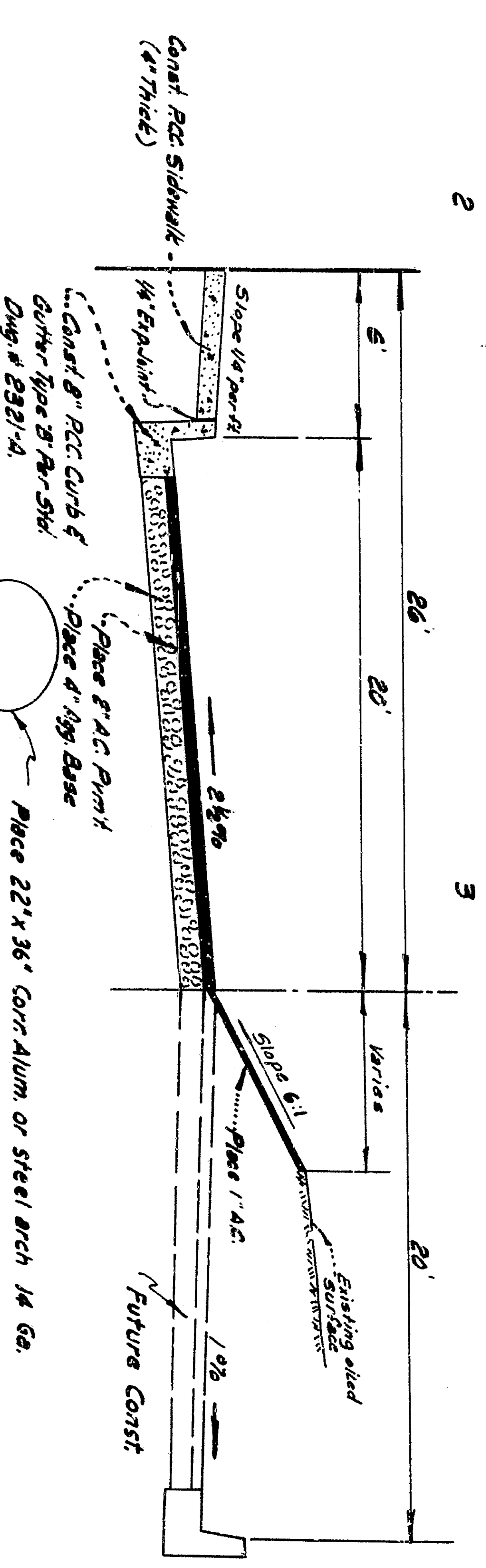

OSBUN ROAD
SCALE: HORIZ. 1"=20'
VERT. 1"=2'



Note: Backfill material for pipe arch and R.C.P. shall be placed in horizontal uniform layers not exceeding 0.67' in thickness before compaction and shall be brought up uniformly on all sides. Backfill material shall extend a minimum of 12" on all sides of pipe. Each layer or backfill shall be compacted to a relative compaction of not less than 95 percent. Backfill material shall have a sand equivalent of not less than 30.

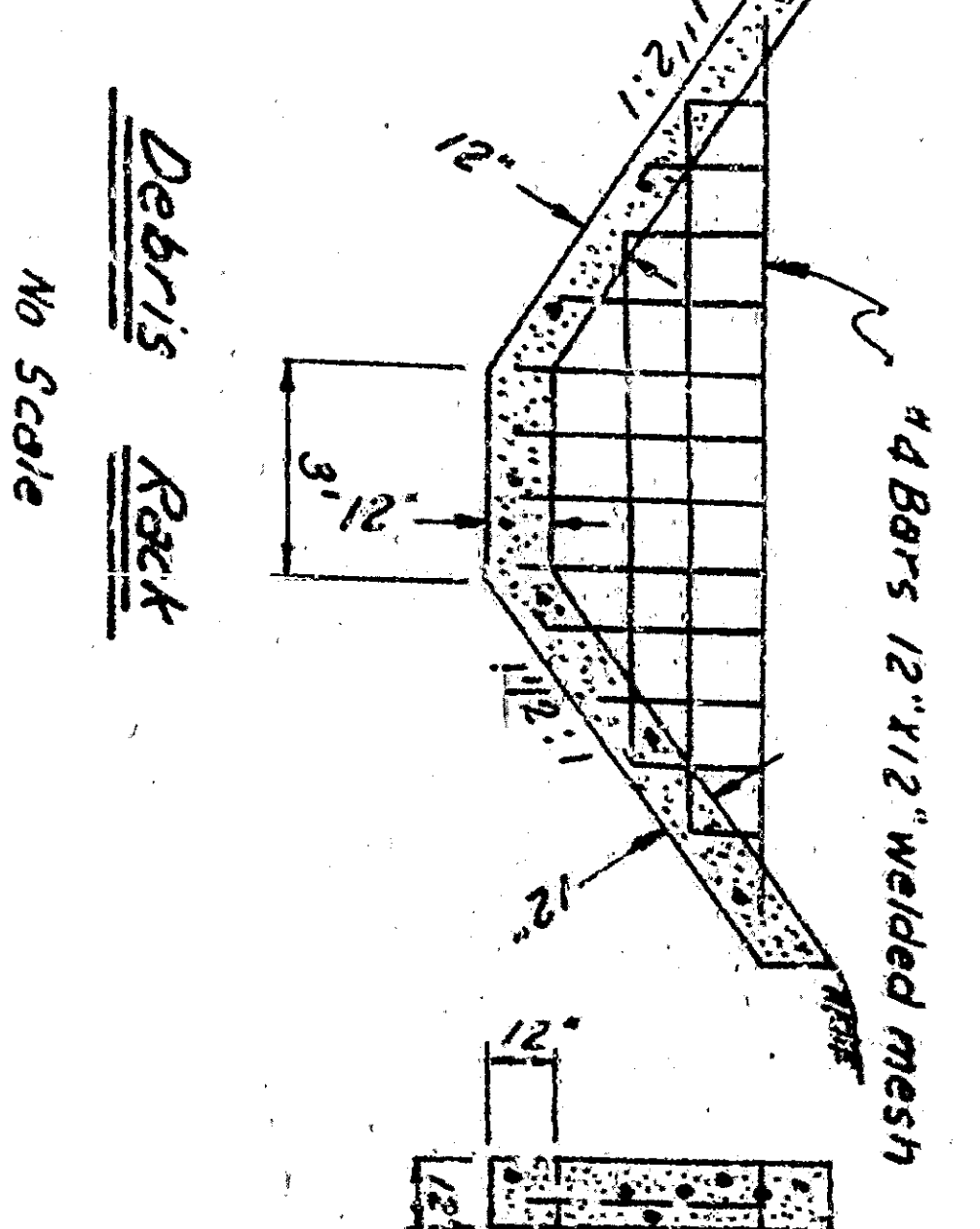

IMPROVEMENT PLANS
HIGHLAND AVENUE &
OSBUN ROAD

APPROVED AND SEALED
3317
2